



How to Replace a 60 Minute Mallory Timer

000218 60 Min. Mallory Timer

Tools Needed

- Flathead Screwdriver or 1/4" Nut Driver
- Philips Screwdriver



Questions?
Give us a call at 1-800-536-9495
or email support@ironaway.com

1



Turn off power at electrical entrance

Please disconnect all power to the unit at service entrance BEFORE attempting to service or rewire the unit.

2



Remove timer knob

Using a flathead screwdriver, gently pry off the timer knob and lay off to the side.

3



Unscrew electrical raceway

With electricity shut off at service entrance, begin removing electrical raceway from unit. Remove screws at the top and bottom of raceway with a flathead screwdriver. Gently pull raceway out of unit, being careful of wires that are still connected.

OP

Optional

Completely remove electrical raceway

For ease of installation, completely remove the electrical raceway by disconnecting the electrical wires. Disconnect the ground wire from the unit, then the main electrical supply wire. If your unit has a spotlight, you may also disconnect this wire.

PLEASE NOTE: Carefully examine the wiring as you will need to reconnect these prior to re-installing your electrical raceway.



Remove timer face screws

Using a Phillips screwdriver, remove the two screws on the sides of the timer face (where the knob had been).

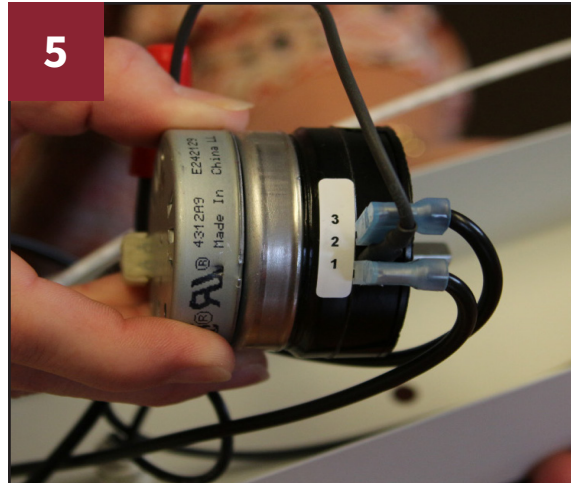

Disconnect old timer

Turn the raceway over so the back is exposed. Lift out the timer and remove the flag shaped connector from marked terminal 1, and then from marked terminal 3.

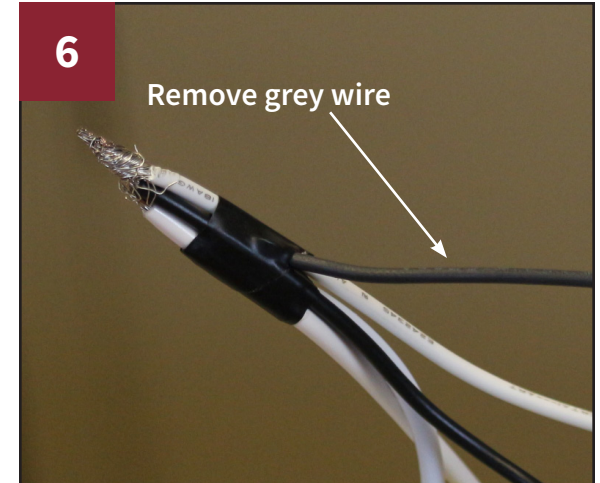

Remove grey wire from bundle

Unscrew the wire nut on the bundle of white wires by twisting nut counter-clockwise. Locate the dark grey wire that connects to timer and remove from bundle by gently pulling it. Then remove timer.



Connect new timer

Connect raceway wires to new timer by first connecting long black wire to terminal marked 1. Then connect the shorter wire to terminal marked 3.



Connect new gray wire

Locate dark gray wire at back of timer and lay it flush with striped ends of white wire bundle. Replace wire nut by screwing clockwise with downward pressure.



Install new timer

Place shaft of new timer through hole in raceway with the three terminals on top pointing towards back of spotlight.



10 Replace face screws and timer knob

Turn raceway over and screw the two face screws on timer face with Phillips screwdriver. You may need to align screwholes before inserting screws. Replace timer knob on new timer by gently pushing onto shaft of timer.



11 Re-install raceway

Being careful not to pinch any wires, replace the raceway to the unit. Replace top and bottom screws. After replacing raceway, restore power to unit.

If you disconnected the raceway from from the ironing center, please re-connect before returning raceway to unit.

Installation Complete!

Questions?
Give us a call at 1-800-536-9495
or email support@ironaway.com

